

DEMOLITION NOTES

DOTTED LINES INDICATE DOORS, WINDOWS, WALLS, FIXTURES, ETC. SHALL BE REMOVED.

DEMOLITION PLAN SHALL BE USED IN CONJUNCTION WITH ALL OTHER PLANS AND ELEVATIONS FOR OPENINGS, LOCATIONS, SIZES, ETC.

CONTRACTOR SHALL PATCH ALL WALL, FLOOR, CEILING, AREAS, ETC. AFFECTED BY DEMOLITION TO MATCH EXISTING CONDITIONS.

REMOVE ALL INTERIOR FINISHES, INCLUDING WOOD, PLASTER, GYPSUM BOARD, CERAMIC TILE, ETC., FROM EXISTING AREAS INDICATED.

CONTRACTOR SHALL PROVIDE TEMPORARY STRUCTURAL SHORING AS REQUIRED TO COMPLETE THE WORK WITHOUT WEAKENING THE EXISTING HOUSE STRUCTURE.

CONTRACTOR SHALL CONSULT WITH THE ARCHITECT SHOULD ANY QUESTIONS ARISE REGARDING UNDERMINING THE EXISTING HOUSE STRUCTURE

DISCONNECT PLUMBING, ELECTRICAL AND DUCT WORK AS REQUIRED, CAP OFF UNUSED PLUMBING AND PROVIDE A RE-ROUTE FOR ABOVE WORK.

SPECIAL CARE SHALL BE TAKEN TO ENSURE THAT NO DAMAGE OCCUR IN ANY OTHER AREAS OF THE HOUSE DURING DEMOLITION OF INDICATED AREAS.

SPECIAL CARE SHALL BE TAKEN TO PREVENT DIRT, DUST AND CONSTRUCTION DEBRIS FROM ENTERING OTHER AREAS OF THE HOUSE. DOORS SHALL BE COVERED AND TAPED.

THE WORK SHALL BE KEPT CLEAN ON A DAILY BASIS. ALL DEBRIS SHALL BE PUT IN A CONTAINER AT DAY'S END.

CONTRACTOR SHALL CONSULT WITH OWNER PRIOR TO DISCARDING AND EXISTING FIXTURES, CABINETS, HARDWARE OR OTHER ITEMS THAT THE OWNER MAY WISH TO RETAIN FOR REUSE.

SAVE DOORS FOR RELOCATION IF POSSIBLE.

PATCH FLOORS AS REQUIRED BY REMOVALS.

43 RIDGE ROAD
LYNDHURST N.J.
201-460-8710

SEAL:
MARK A. STEFANELLI R.A.

NJ ARCH NO. 21 A103245
NOT VALID FOR SEALING UNLESS SIGNED AND SEALED BY ARCHITECT

PROJECT:
ADDITION AND ALTERATION TO:
NORTH CALDWELL N.J. 07004

ISSUED: _____ DATE: _____
SCHEMATIC DESIGN _____
BD SET _____
PERMIT SET _____

THESE DRAWINGS ARE THE PROPERTY OF THE ARCHITECT AND SHALL NOT BE COPIED, REPRODUCED OR ALTERED IN ANY FORM WITHOUT THE WRITTEN CONSENT OF THE ARCHITECT

CAD FILE NAME:
REVISIONS
NO. REQUESTED BY: _____ DATE: _____

DO NOT SCALE DRAWINGS
PROJECT NAME
NAME

DATE: 07/21/08
DRAWN/CHECKED: MAS
SCALE: AS NOTED
PROJECT NO. 2008
SHEET NO.

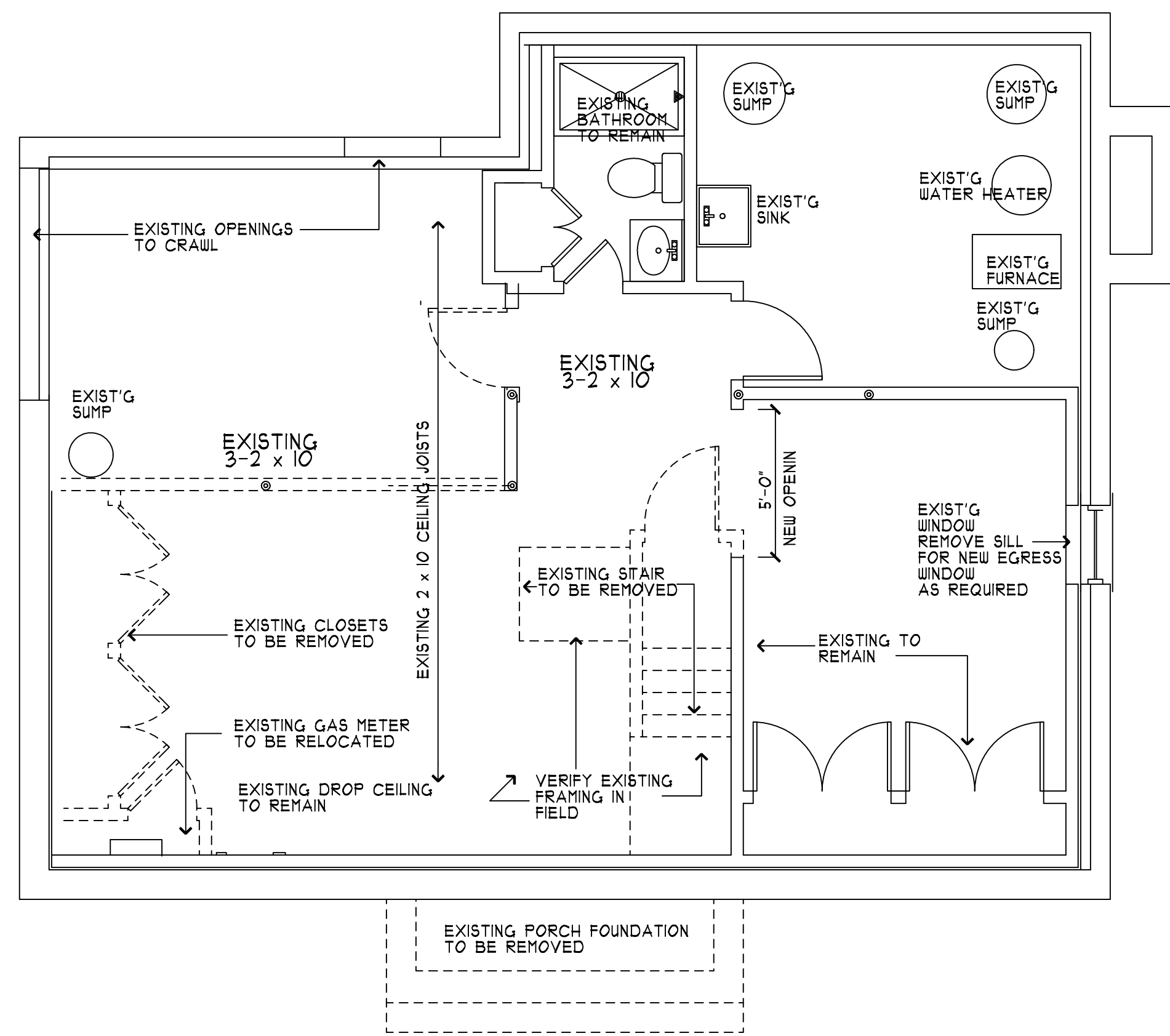

BASEMENT DEMOLITION PLAN

SCALE: 1/4" = 1'-0"

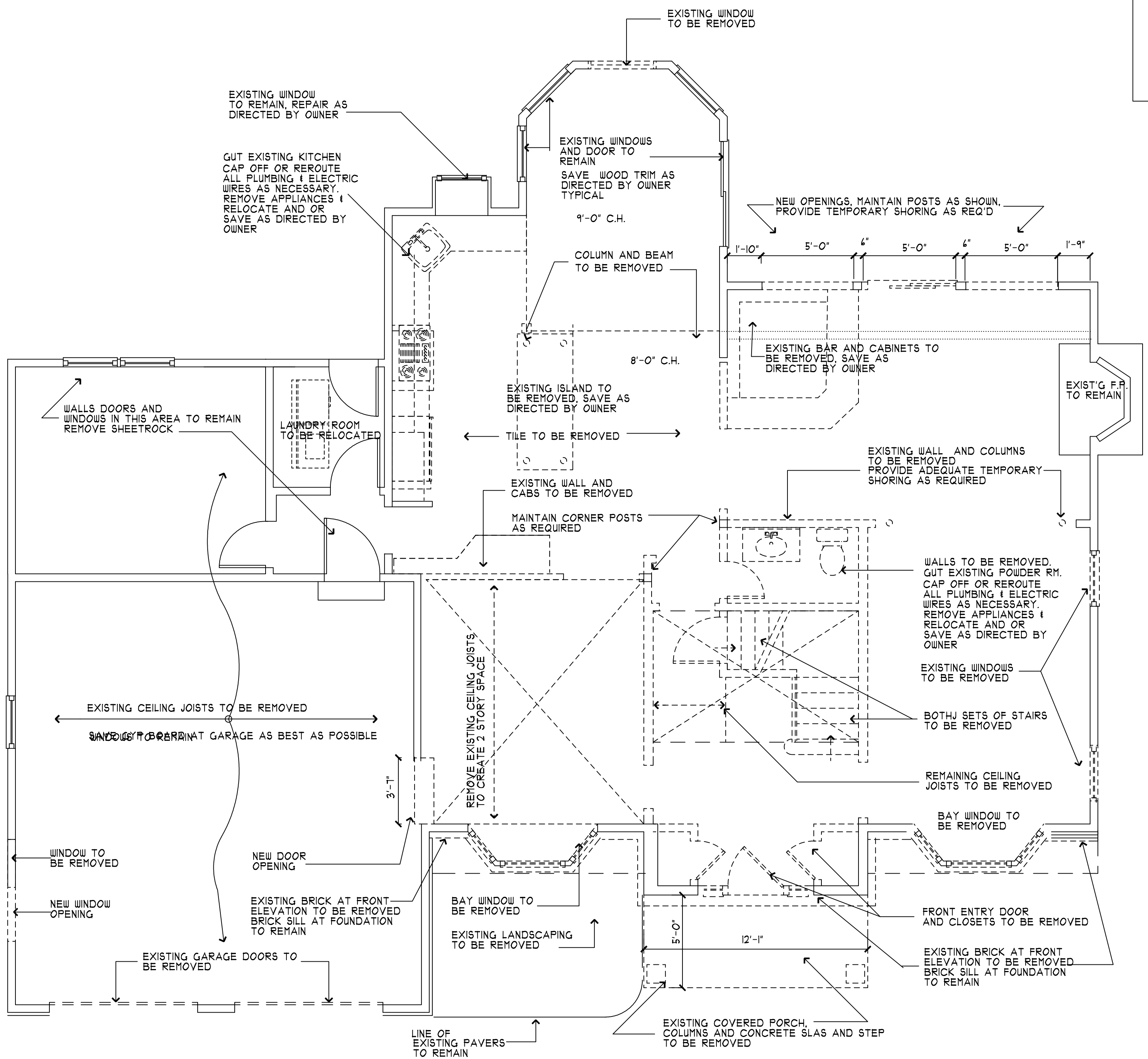

FIRST FLOOR DEMOLITION PLAN

SCALE: 1/4" = 1'-0"

DEMO NOTE:
G.C. TO GUT EXISTING HOUSE DOWN TO STUDS. REMOVE ELECTRICAL AND PLUMBING AS REQUIRED.
REMOVE EXISTING WALLS AND FIXTURES AS INDICATED. SHORE UP EXISTING STRUCTURE ALONG EXTERIOR WALLS ABOVE PRIOR TO REMOVING WALLS (TYP.) CONSULT WITH ARCHITECT AS NECESSARY.

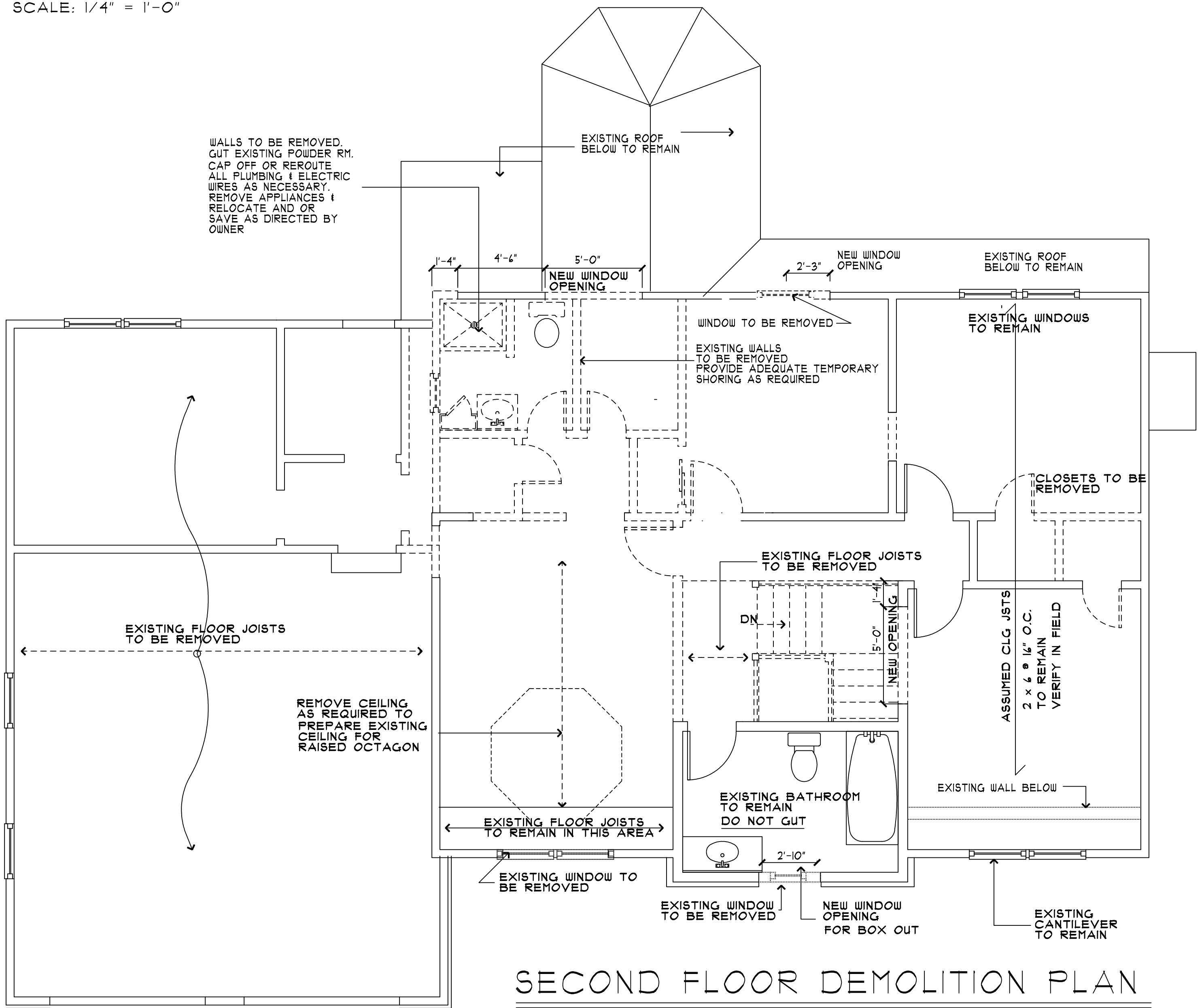

SECOND FLOOR DEMOLITION PLAN

SCALE: 1/4" = 1'-0"